

# Building 313

Residential Blueprints  
and  
Home Design

drawn using  
Autodesk Revit

Building 313  
Megan Musgrove  
P.O. Box 1079  
Dover, AR 72837  
  
479-857-0903  
www.building313.com  
building313@hotmail.com

NOTES:  
  
ALL MODELS TO  
BE BUILT AT 1:24  
SCALE (1/2"=1')

Dover Middle School  
Dover, AR  
E-cybermission Team  
Elements of Surprise

Prototype 4  
Friction Pile  
Foundation

Project number 1329 - 4  
Date Project Issued 2/5/2013  
Date Project Plans Completed

A104

Scale 1/4" = 1'-0"

3/4/2013 9:35:28 PM

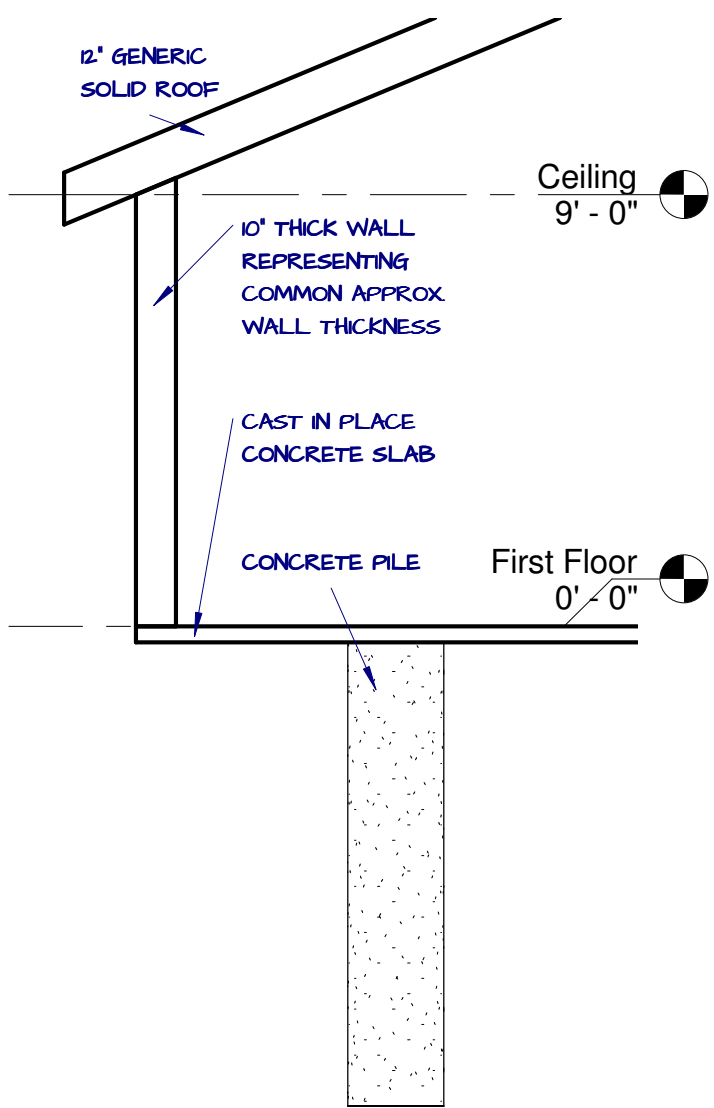

① Section 1  
1/4" = 1'-0"

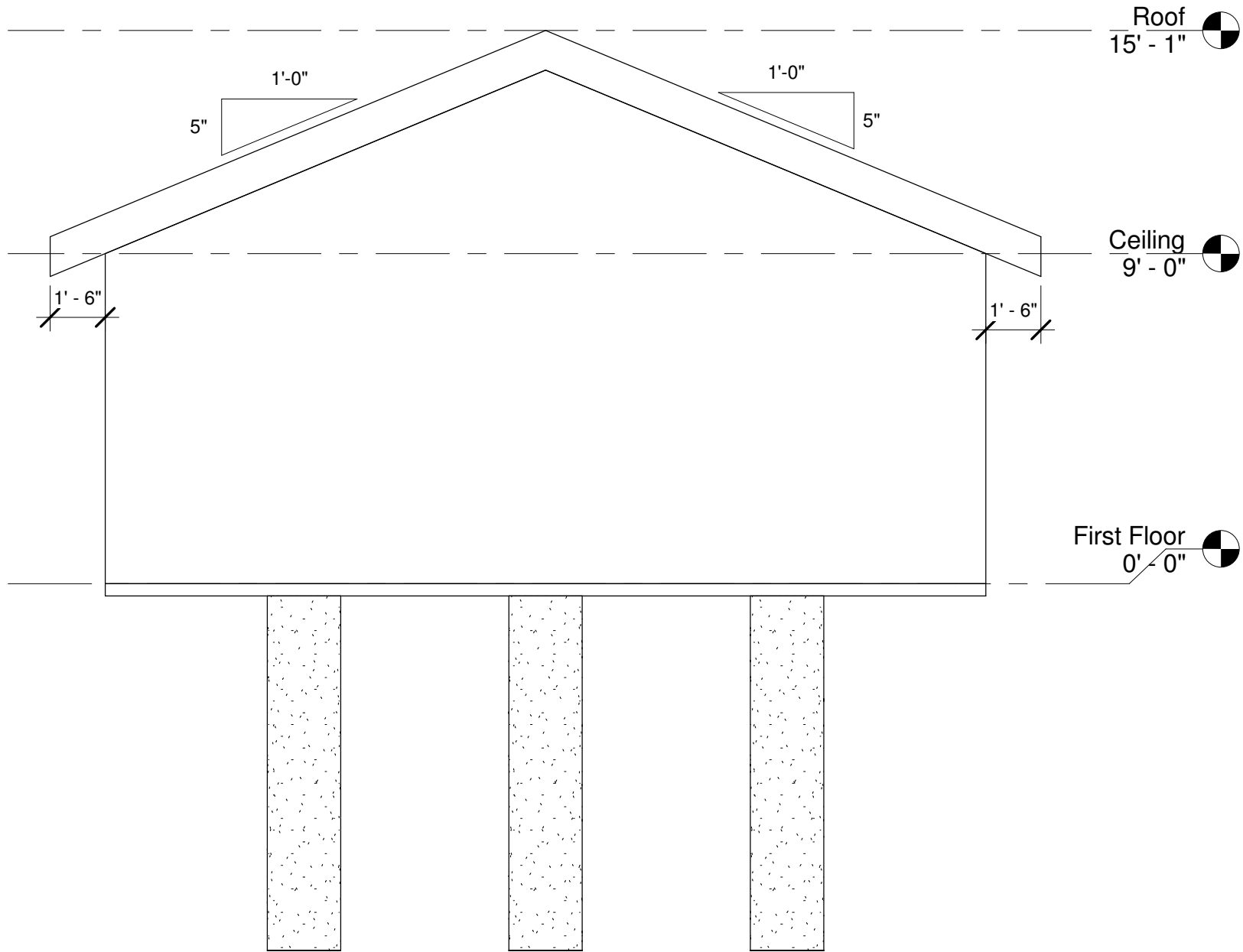

② Right Side  
1/4" = 1'-0"

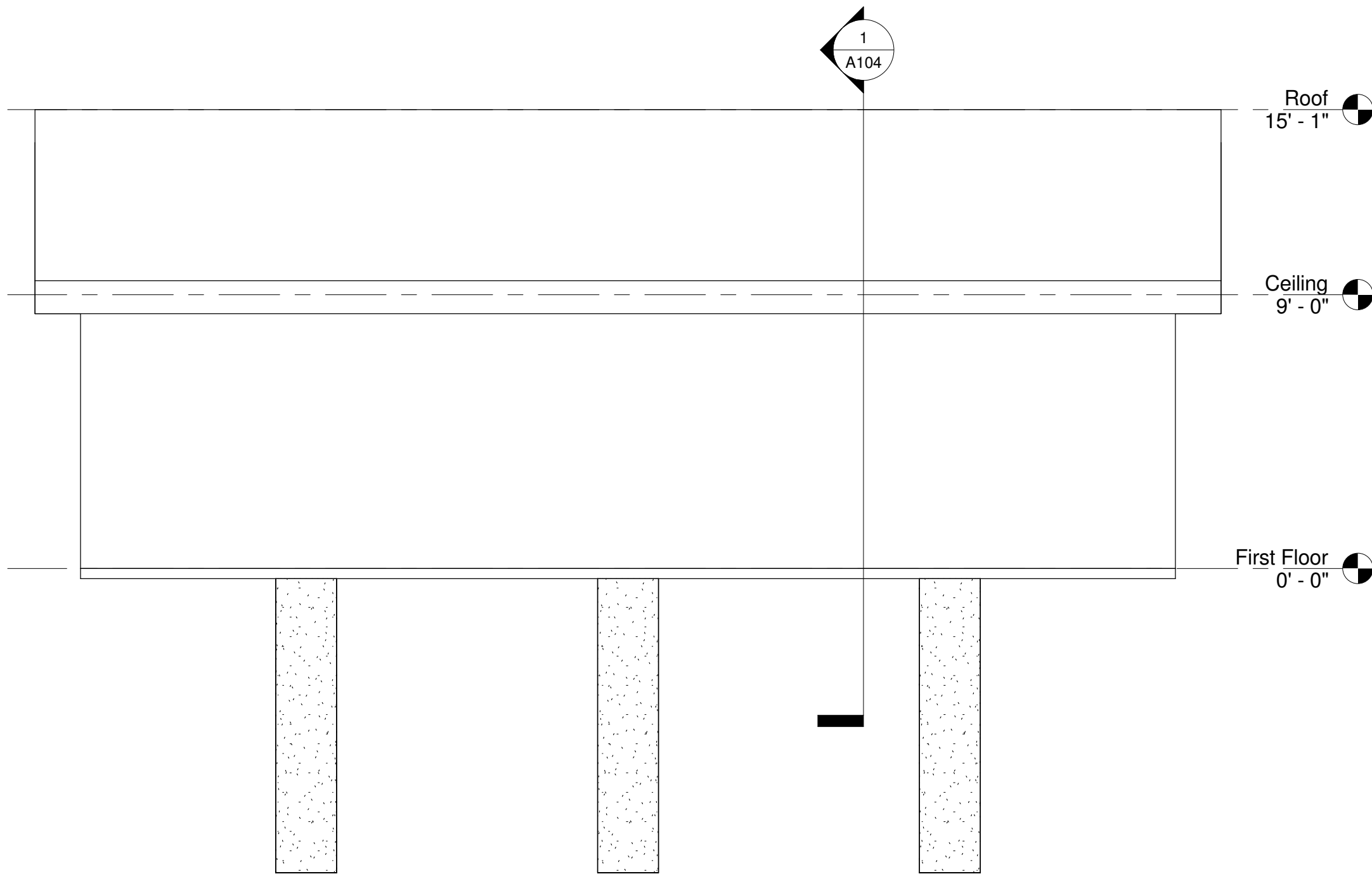

③ Front  
1/4" = 1'-0"

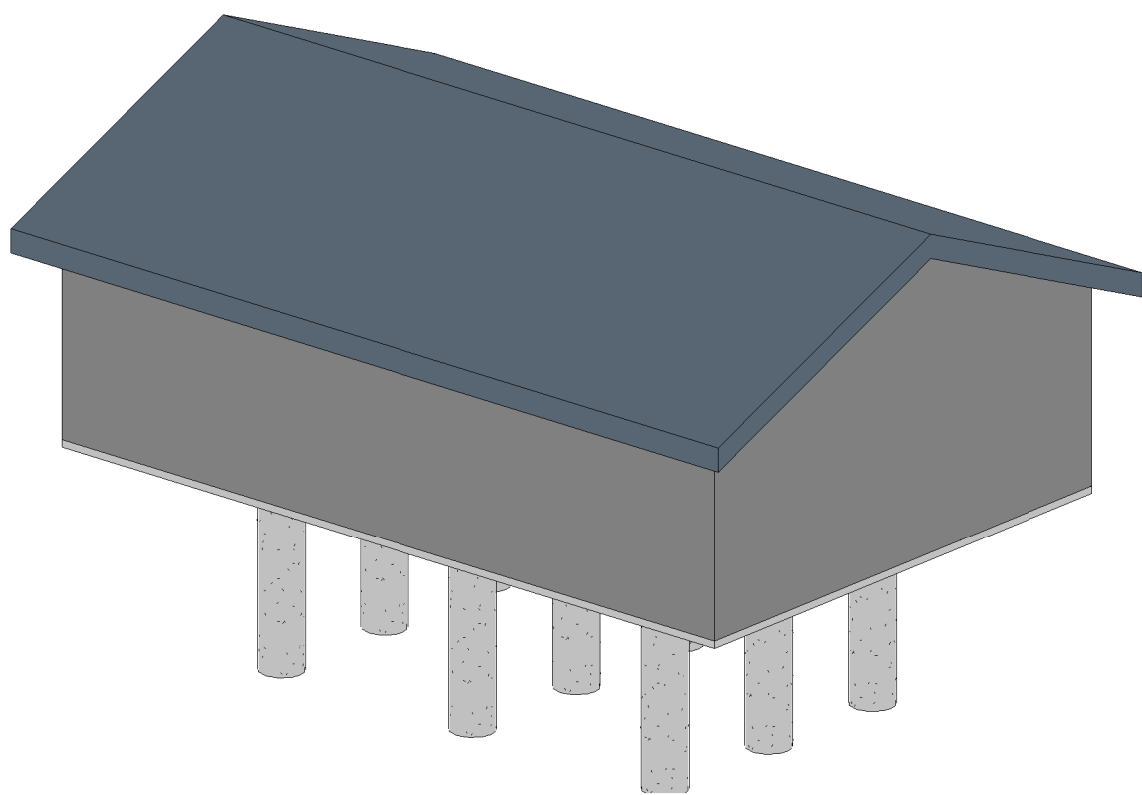

④ 3D 1

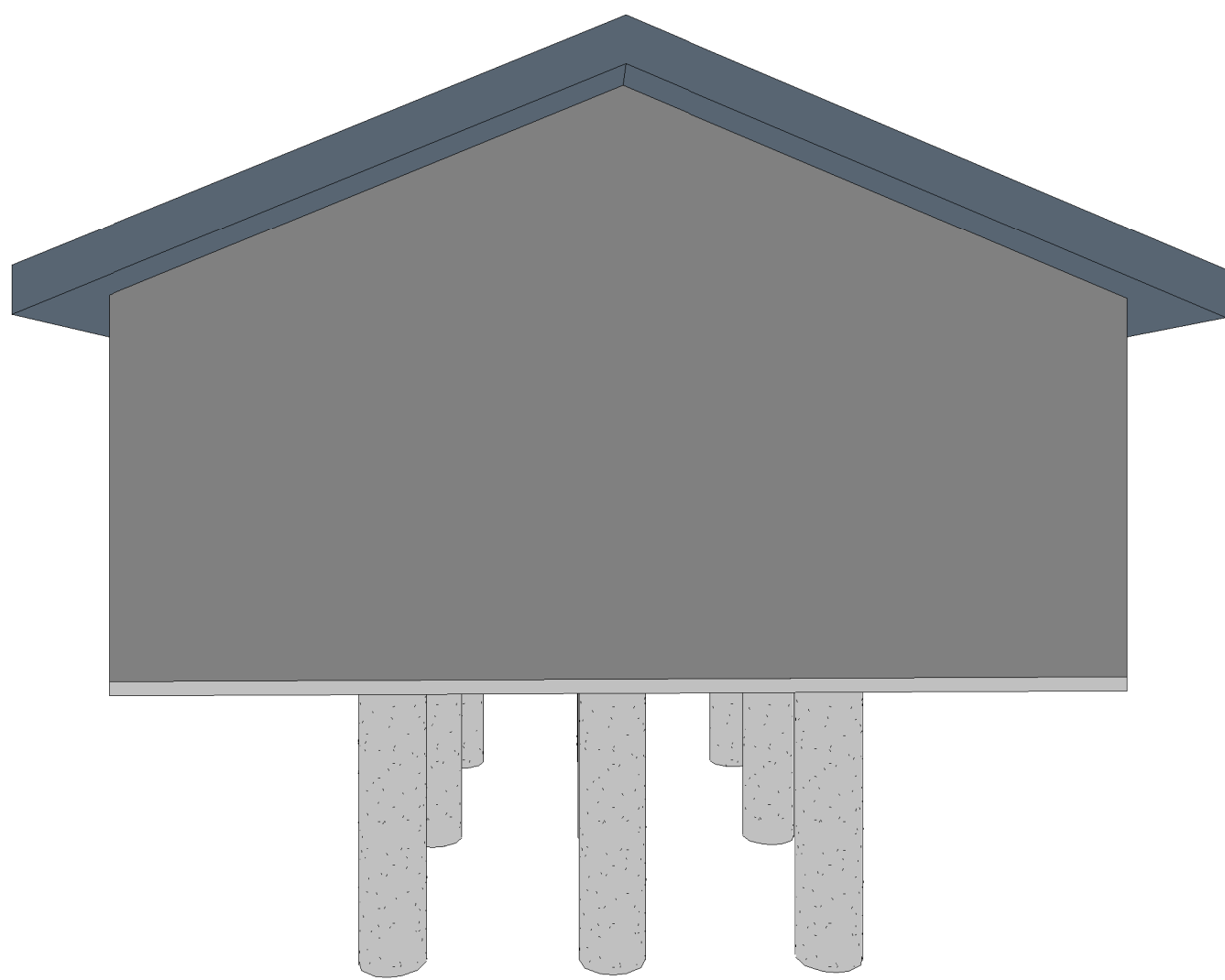

⑤ 3D 2

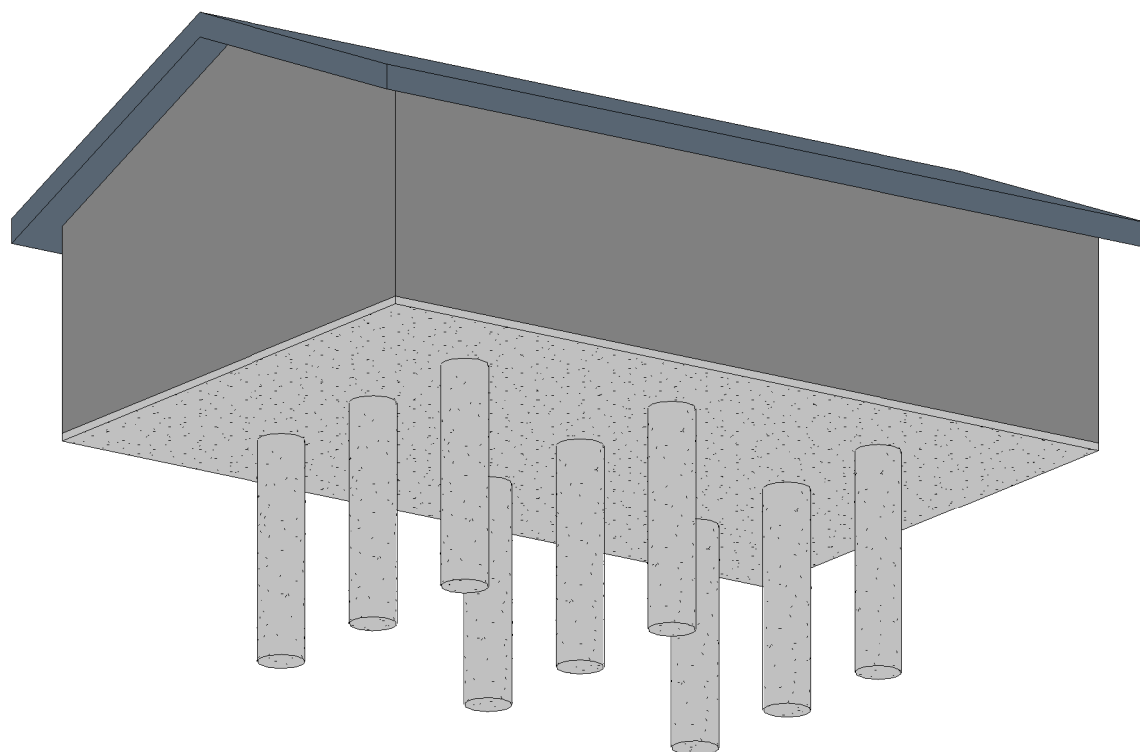

⑥ 3D 3